

# SKETCH/AREA TABLE ADDENDUM

File No 14111801

SUBJECT

|                  |       |     |
|------------------|-------|-----|
| Property Address |       |     |
| City             | State | Zip |
| Borrower         |       |     |
| Lender/Client    |       |     |
| Appraiser Name   |       |     |

IMPROVEMENTS SKETCH

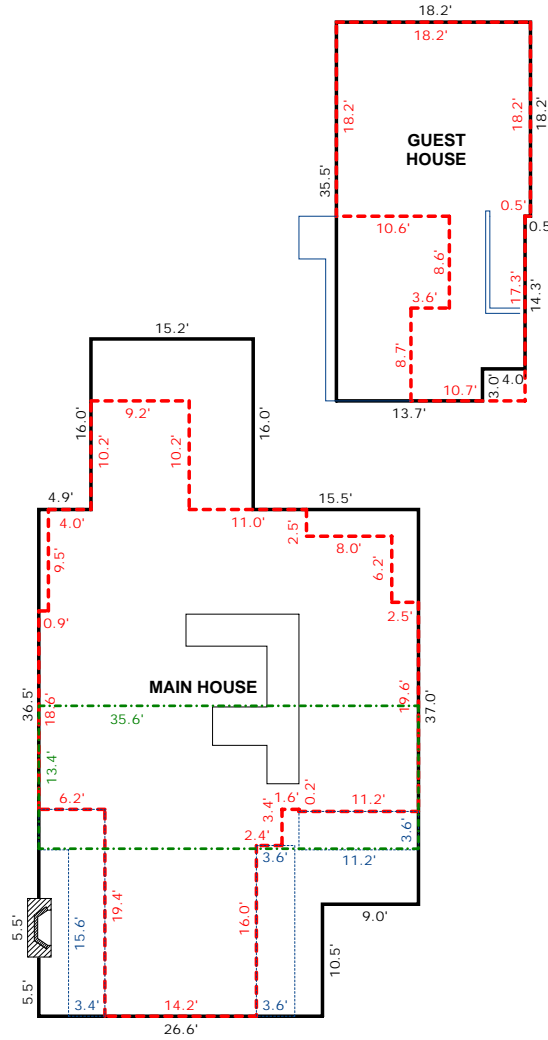

Scale: 1" = 18'

AREA CALCULATIONS

## AREA CALCULATIONS SUMMARY

| Code             | Description     | Net Size  | Net Totals |
|------------------|-----------------|-----------|------------|
| GLA1             | MAIN 1st Floor  | 1839.70   | 1839.70    |
| GLA2             | MAIN 2nd Floor  | 1329.78   | 1329.78    |
| GLA4             | GUEST 1st Floor | 625.45    | 625.45     |
| GLA5             | GUEST 2nd Floor | 485.39    | 485.39     |
| BSMT             | MAIN Basement   | 477.04    | 477.04     |
| Net LIVABLE Area |                 | (rounded) | 4280       |

## LIVING AREA BREAKDOWN

| Breakdown              |           | Subtotals |
|------------------------|-----------|-----------|
| <b>MAIN 1st Floor</b>  |           |           |
| 26.6 x                 | 10.5      | 279.30    |
| 16.0 x                 | 15.2      | 243.20    |
| 37.0 x                 | 35.6      | 1317.20   |
| <b>MAIN 2nd Floor</b>  |           |           |
| 35.6 x                 | 18.6      | 662.16    |
| 0.8 x                  | 34.7      | 27.76     |
| 0.2 x                  | 11.2      | 2.24      |
| 3.4 x                  | 16.6      | 56.44     |
| 10.2 x                 | 9.2       | 93.84     |
| 2.5 x                  | 24.2      | 60.50     |
| 6.2 x                  | 32.2      | 199.64    |
| 16.0 x                 | 14.2      | 227.20    |
| <b>GUEST 1st Floor</b> |           |           |
| 3.0 x                  | 13.7      | 41.10     |
| 18.2 x                 | 18.2      | 331.24    |
| 14.3 x                 | 17.7      | 253.11    |
| <b>GUEST 2nd Floor</b> |           |           |
| 10.7 x                 | 8.7       | 93.09     |
| 8.6 x                  | 7.1       | 61.06     |
| 18.2 x                 | 18.2      | 331.24    |
| 17 Items               | (rounded) | 4280      |